

Directions to H & H Stables

From I20 coming from Dallas

Take exit 47 go right on 47

Cross over flashing lights (243)

Left on 2418 (next left past 2420)

Second left is 2410, go left on 2410, yellow brick house on the left is 2650 with the walking horses.

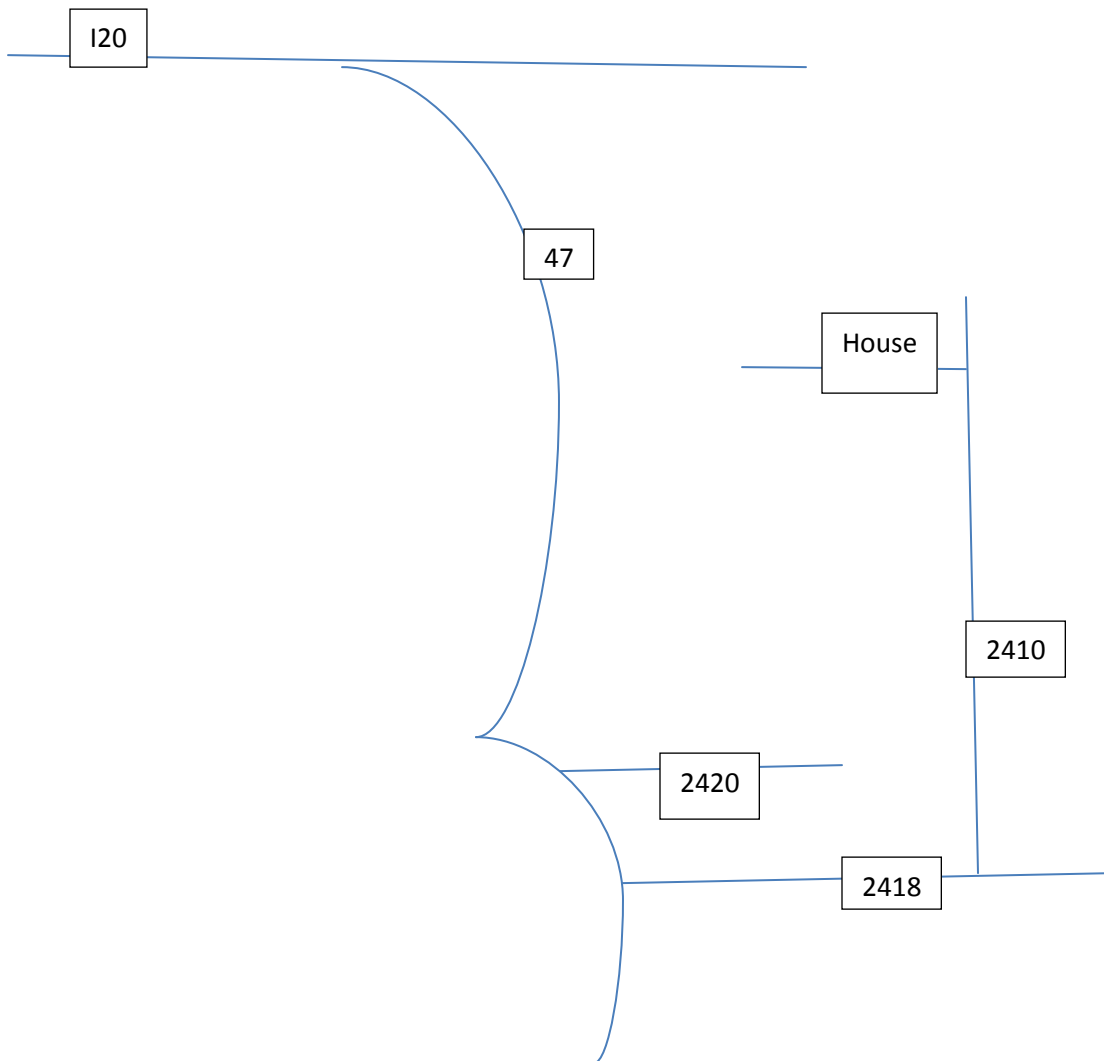

From I20 coming from Tyler/Longview

Take exit 19 Canton

Right on 243 (3rd traffic light by the CVS on the right)

Left on 198

Right on 2403

Go to the where you have either go left on right go left on 2410, on the right 2650 with the walking horses.

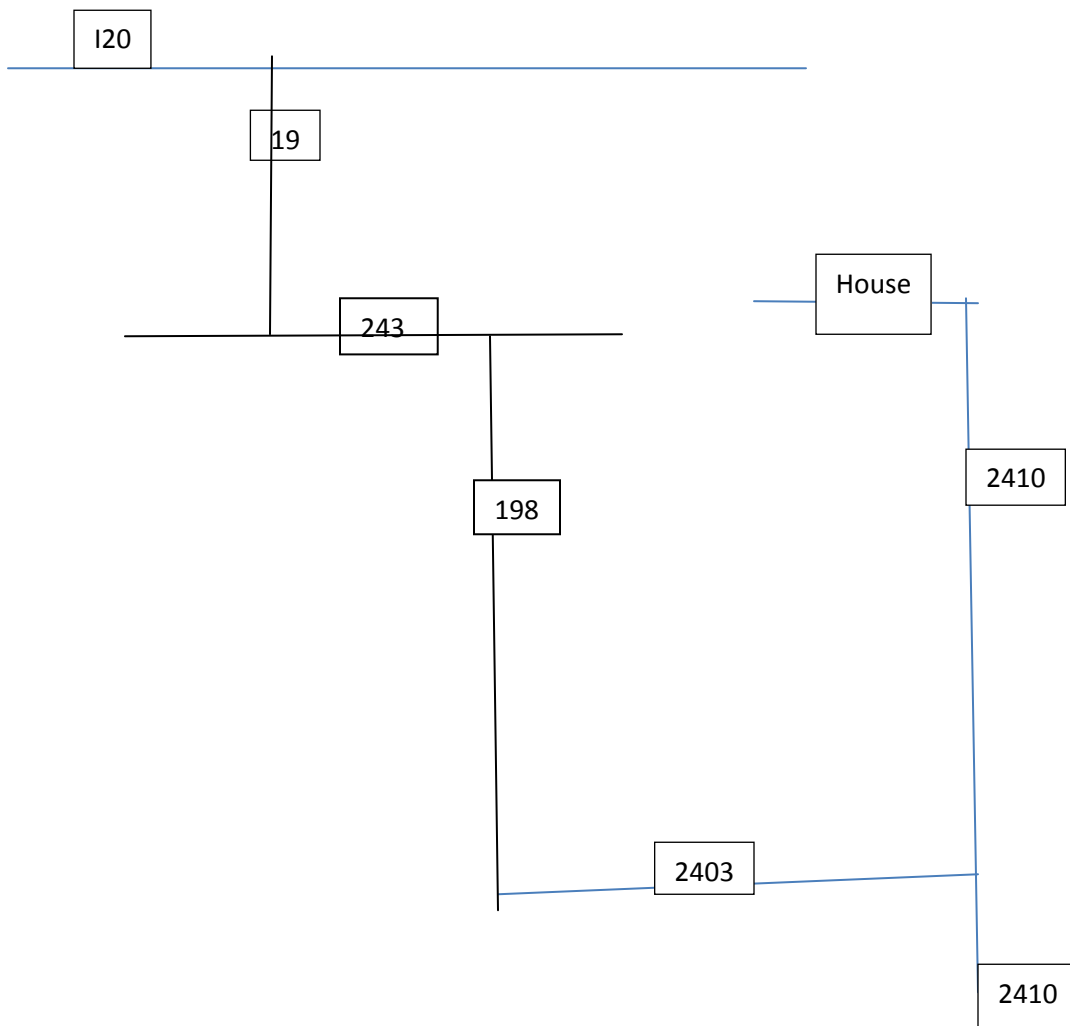

From 175 coming from Dallas, at a left at Kaufman/Canton exit. At the stop sign go through to the yield and go right, go part way around the courthouse to the traffic light. Go through the traffic light on to 243 stay on 243 until you get to Van Zandt County.

Right on 47. 47 is at the flashing yellow traffic lights after you enter Van Zandt county.

Left on 2418 (next left past 2420)

Second left is 2410, left on 2410, yellow brick house on the left, 2650 with the walking horses.

